

Loveseat Return Guide

- ◆ Call Home Reserve Customer Service 800-482-2712 and let us know about the return so we can help coordinate it.
- ◆ Repack the wood parts into the frame boxes. There is a diagram on how all the parts fit on the next page. Put the parts bag back into the frame box as well.
- ◆ Fold up all the fabric covers so that they are not wrinkled and place them back into the fabric bag. This bag goes in the bottom of the foam box.
- ◆ In order to get the all the foam and back cushions back into the foam box use large garbage sized plastic bags and a vacuum. Put a couple pieces of the foam or back cushions into the plastic bag, wrap the bag around the nozzle of a vacuum hose and shrink the foam down by drawing all the air out. We've included a photograph of this process.
- ◆ Tape or band all the boxes securely.
- ◆ Take the packages to a UPS store near you (www.UPS.com) and address them to the following address.

**Home Reserve
3015 Cannongate
Fort Wayne, IN 46808
260.969.6939**

Weights & dimensions for shipping detail:

Loveseat Frame box: 63 pounds 5" height, 18" width, 55" length

Loveseat Foam & Fabric box: 30 pounds 21" length, 17.5" width, 29.5" height

Loveseat Frame repacking

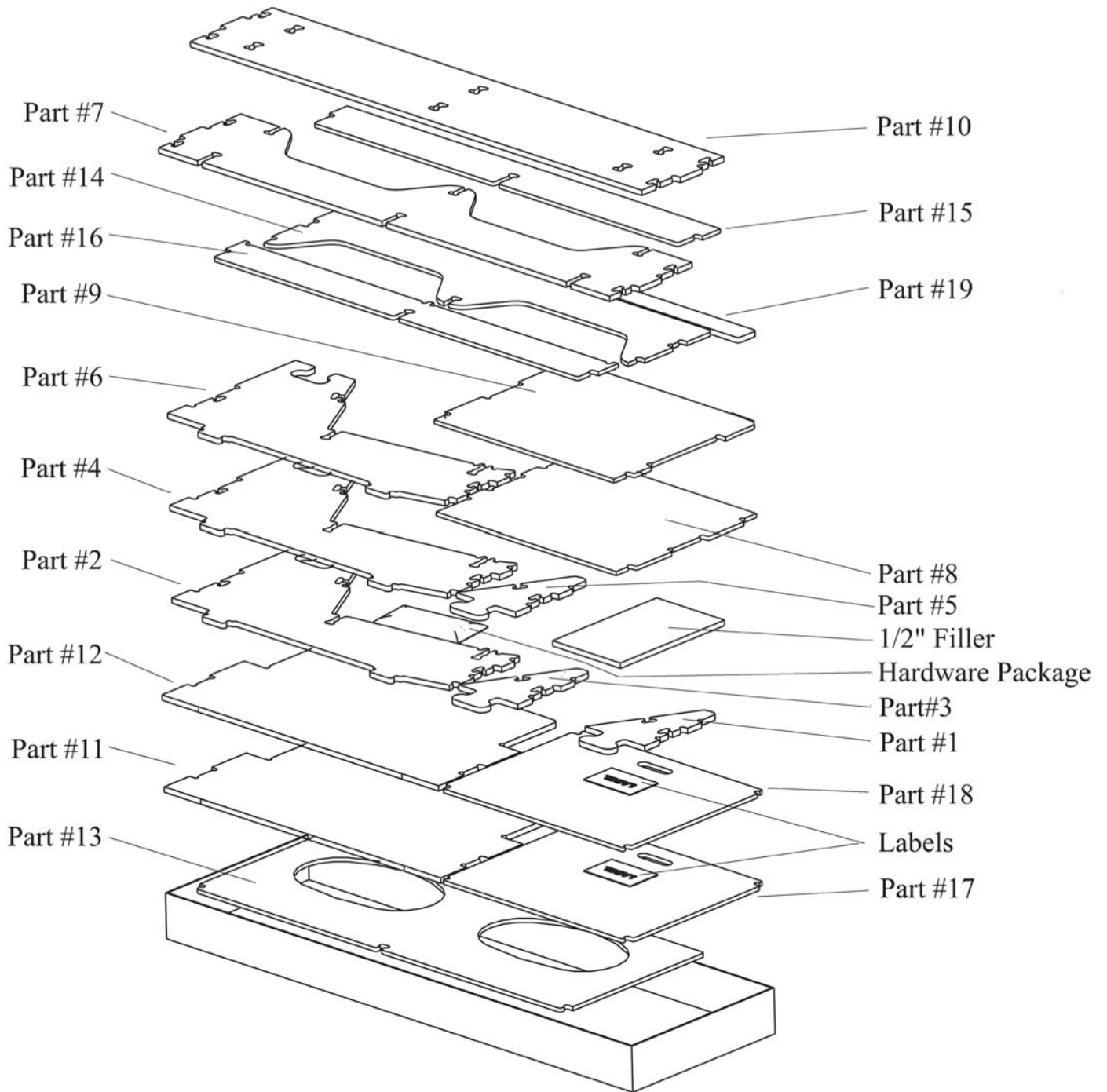

Foam Repacking

Photographs of how to shrink foam down using garbage bags and vacuum.



Once you have the foam back inside the boxes use strapping tape to cinch the box tightly closed. The compressed foam will begin to expand in the plastic bags-the bags leak air and it's really the strapping tape that will keep the box compressed.